

OREGON PUBLIC LAND CORNER REPORT / RESTORATION REPORT  
Tillamook County Surveyor's Office

BOOK 8 220

SECTION: 17, 18, 19 & 20	TOWNSHIP: 3 North	RANGE: 10 West
COUNTY: Tillamook	DATE: 4/16/2024	
CORNER DESIGNATION: The Section corner common to Sections 17, 18, 19 AND 20 Township 3 North, Range 10 West; Willamette Meridian	(Please check one)	
	X	Condition Report Only
		Restoration
		Rewitness
		Unrecorded
		Reset at surface
		Referenced Out

Previous Rewitnesses, Restorations and Surveys, etc...  
BLM-OREGON Field note Volume: OR-R0053 Page 503.000 (1857), Rewitness Bk. 1, Pg. 492 (1961), Rewitness Bk. 3, Pg. 17 (1965), Rewitness Card #125 (1973), Rewitness Bk. 6, Pg. 166 (1975), Rewitness Card #125 (1994), B-4135 (2021)

History, condition, and sources  
(BLM Field notes 1857) A scribed post was set for the section corner and two bearing trees established. In 1961 (Rewitness Bk. 1, pg. 492) W. A. Markham set 1" drill bit in place of the scribed post for the Section corner and established one bearing tree. In 1973 (Rewitness Card #125) Tillamook County Surveyor's office set a 2" iron pipe with a 3" Tillamook County brass cap in 10" tile filled with concrete and stamped "T3NR10W S18 S17 S19 S20 RS 287 1973" in place of found 1" drill bit and established two bearing trees. In 1975 (Rewitness Bk. 6 Pg. 166) John Hollingsworth placed parks corner tag on one bearing tree and added a steel post with a corner location tag. In 1994 (Rewitness Card #125) Tillamook County Surveyor's office established two new bearing trees. In 2025 (Field Bk. MR 18 Pg. 3 & 4) the Tillamook County Surveyor's office found a 3" Tillamook County Surveyor's brass disk in tile filled with concrete stamped as shown hereon. The found accessories are listed below.

- Found: (Rewitness Card #125 1973: 14" dia. fir N69°E 9.15') (Rewitness Card #125 1994 26" dia. fir.) Now 30" dia. with healed scar and white do not cut tag.
- Found: (Rewitness Card #125 1973: 40" dia. fir N76°W 66.95') (Rewitness Card #125 1994: 40" dia.) Now 44" dia. fir with healed scar and white metal do not cut tag.
- Found: (Rewitness Card #125 1994: 10" dia. fir S31°W 10.84). Now 20" dia. with healed scar no tag.
- Found: (Rewitness Card #125 1994: 27" dia. double fir S55°E 15.29'). Now 30" dia. with healed scar and yellow metal location tag embedded in the tree.
- Found (Rewitness Card #125 1973: 72" hat section post North 1.5') (Rewitness Card #125 1994 North 2.5'). Now at the location of Rewitness Card #125 1994.

New accessories set:

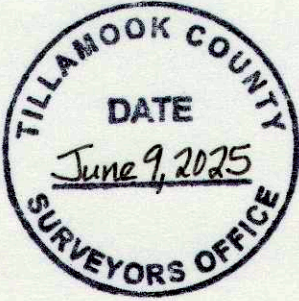

Pictures of Found Monuments:



Location: ±1300' North of the entrance to Neah-Kah-Nie Meadows along Hwy 101 and ±140' up a steep hillside.

Tillamook County Surveyor office: 1510 3<sup>rd</sup> Street Suite C, Tillamook, OR. 97141

Party Chief: Travis Porter, Tillamook County Survey Technician III

Witnesses: Michael Rice P.L.S. 86926, Tillamook County Surveyor  
Kael Poklikuha, Tillamook County Survey Technician II

Notes: Digital images taken of monument and accessories.

SURVEYOR'S SEAL



BOOK 8 220